

PORTELLA
STEEL DOORS & WINDOWS



Unforgettable first impressions.



Modern, classic or traditional, Portella delivers solutions and superior products.

Portella offers flexible steel door and window design solutions. Limitless design options are available to complement your contemporary building project or historical replication.

Portella has created the following series to withstand the most extreme conditions and meet any design application:

Artisan Series

Classic Series

Storefront Exterior and Interior Series

Factory-installed glass, old world artisan, high quality workmanship, customization, and superior customer service makes us unique in our industry. Portella has earned a reputation that is as strong as our steel construction.

PORTELLA
STEEL DOORS & WINDOWS

ELEGANT NARROW SIGHTLINES

As North America's leading manufacturer of custom steel windows and doors, our proven business model and precise communication deliver value in more ways than exceptional windows and doors.

PORTELLA FEATURES:

- Trademark narrow-profile minimal sightlines
- Factory installed glass with Low-E options for maximum energy efficiency
- NFRC rated
- Laser fusion welded
- Wet glazed glass glazing system eliminates any possibility of moisture penetration
- Clear and concise communication from quotation to shop drawings – details are accurate
- Tested and engineered designs.
- Portella Project Managers assigned to every project for next-level customer service





OUR HIGH-PERFORMING THERMAL STEEL PRODUCTS ARE IDEAL FOR MORE EXTREME CLIMATES.



For the past three decades the design of windows has been driven by regulations to increase thermal performance, rather than by their original scope, which is to enhance the beauty of buildings. Portella's Artisan Steel Series exceed all current energy efficiency requirements.

- Precision Carbon Steel profiles
- Solid Bronze, Stainless Steel and Corten available
- True thermal broken frame and sash
- Paten Made In House Thermal Bonding Extrusions
- Innovative poly-core thermal barrier eliminates cold and heat transfer
- 1" Simulated Divided Lite option for greater energy value
- 1" or 1-1/4" True Divided Lite option for old world look and feel
- Corner Welded Glazing Bead (not just caulked) to avoid leaking in corners
- Five optional glazing bead options
- NFRC Rated to comply with building code
- Dual insulated Cardinal LowE glass with optional Triple Glaze for added insulation
- Factory wet glaze glass system eliminates exterior moisture penetration
- Multi Point Weather-Strip contacts
- Welded stainless steel hinges with vertical adjustable hinge post
- 4 Different Continuous Solid Steel Welded Nail Flange options for added strength and moisture protection
- Thermally-bonded zinc galvanizing corrosion resistant coating.
- Premium Paint Finishes: Six matte and Five Patina
- Exceptional 10-year warranty
- Outstanding service from Concept to Completion

ARTISAN STEEL AVAILABLE IN:

- FIXED WINDOWS
- CURTAIN WALL SYSTEMS
- CASEMENT WINDOWS- PUSH OUT AND ROTO CRANK OUT
- AWNING WINDOWS- PUSH OUT AND ROTO CRANK OUT
- GAS SPRING AWNING WINDOWS
- HOPPER WINDOWS
- SLIDING AND MULTI-SLIDE WINDOWS
- LIFT & SLIDE WINDOWS
- TILT & TURN WINDOWS
- HORIZONTAL & VERTICAL CENTER PIVOT WINDOWS
- CIRCLE, OVAL, OCTOGON, RAKE SHAPE WINDOWS
- BUTT GLAZED CORNER WINDOWS
- SWING IN & SWING OUT DOORS
- FIXED AND OPERABLE SIDELITES
- BI-FOLD DOORS
- SLIDING AND MULTI-SLIDE STACKING DOORS
- SLIDING AND MULTI-SLIDE POCKETING DOORS
- LIFT & SLIDE STACKING DOORS
- LIFT & SLIDE POCKETING DOORS
- PIVOT DOORS
- DUTCH DOORS

ARTISAN STEEL DOOR DETAILS:

Opening Configurations

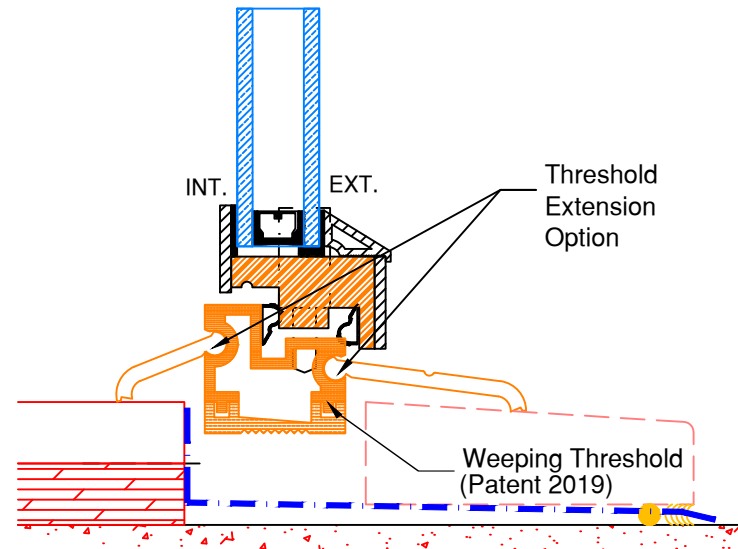
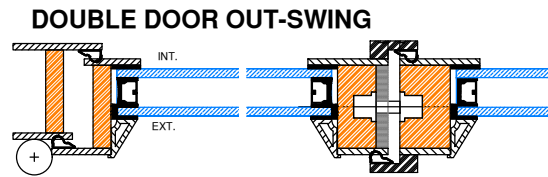
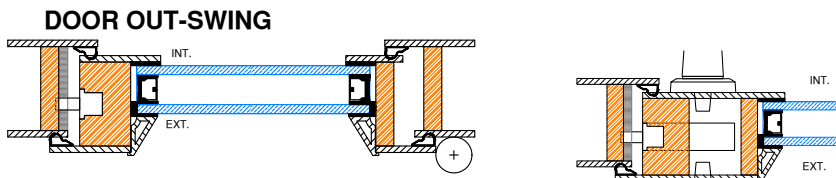
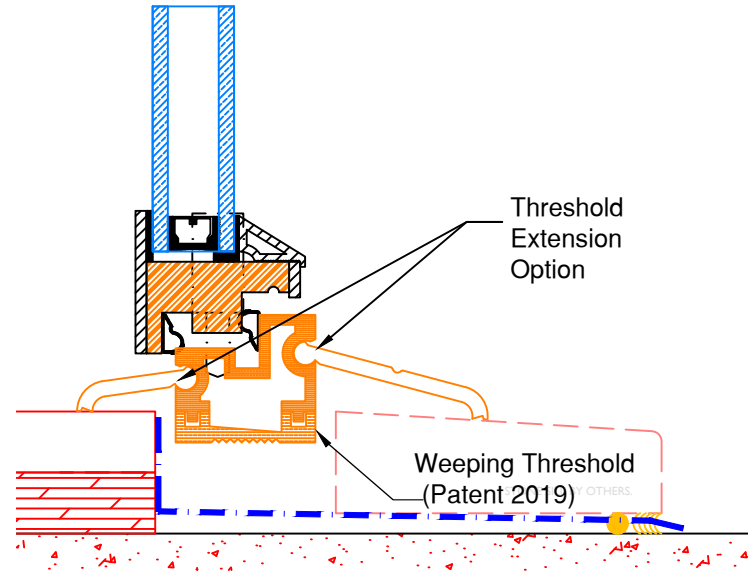
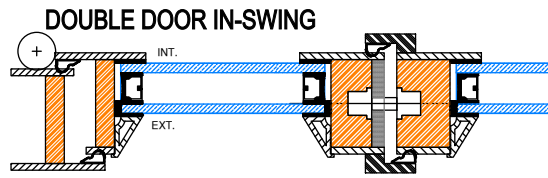
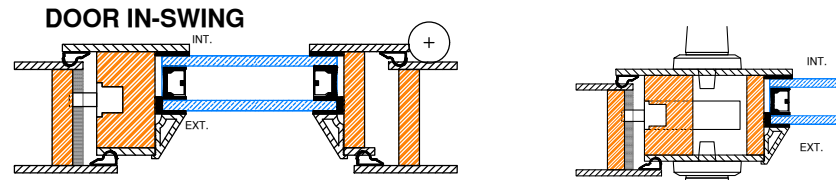

STANDARD FEATURES

- Same Height Bottom Rail on Doors and Sidelites for even Sight Lines
- 5 Point Multi-Point Lock on Active Door
- 2 Point Multi-Point Head and Sill Lock on Passive Door
- Patent Solid Bronze Weep Threshold on In & Out Swing Doors
- Welded stainless steel hinges with vertical adjustable hinge post



ARTISAN SERIES STEEL WINDOW DETAILS:

Opening Configurations

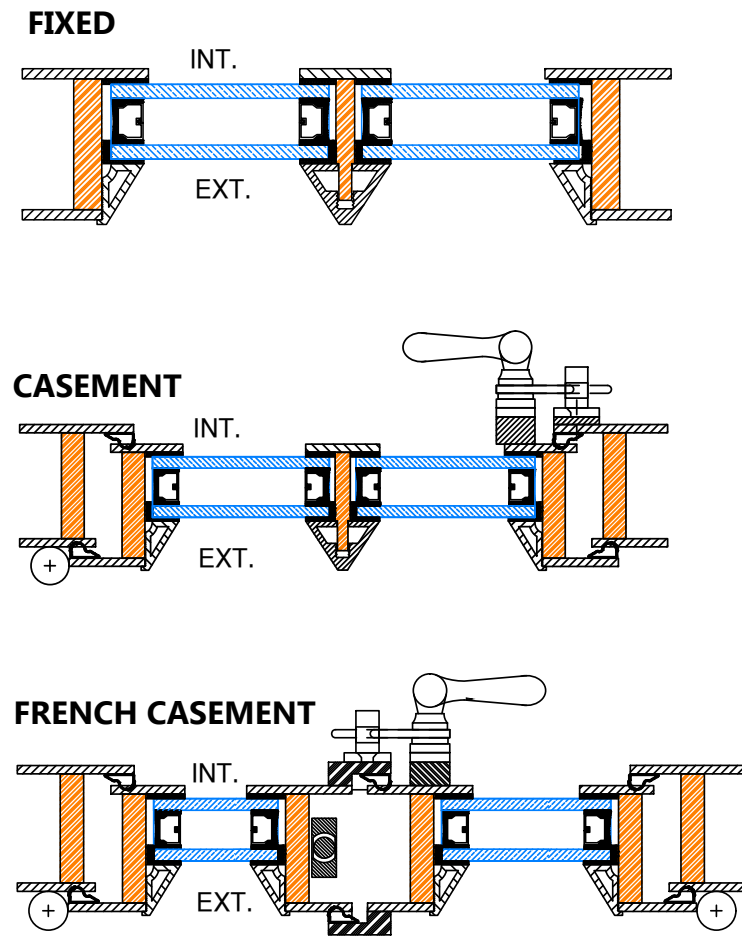

Exterior Detail



Mounting Flange for
Moisture Control and
Structural Integrity

Stainless Steel
Adjustable Hinges

Seamless, Beveled
Deep Glazing

Tight Reveals

Crisp, Clean
Points of Intersection

Interior Detail

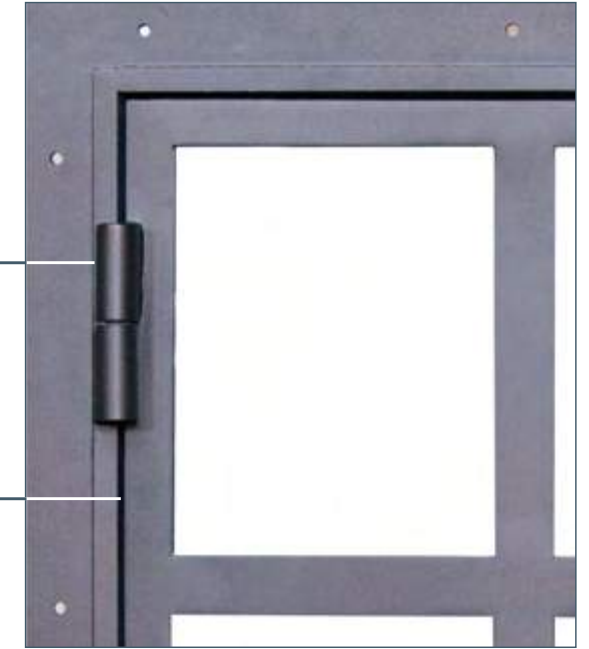

For hinge, awning, hopper, bifold, and sliding configurations visit our website at PORTELLA.COM

Factory glazing allows us to maintain strict standards of quality. Signature beveled wet glazing system ensures against moisture penetration.



The minimal aesthetics of solid steel sections combined with the master of old world artistry and their ability to shape windows is unique. The slender lines appear to lose weight and to give lightness to the frames, emphasizing the transparency of the façade.



- Thickest Steel used in the industry yet the thinnest profiles available anywhere
- Strong Precision Cut Carbon Steel Profiles
- Solid Bronze, Stainless Steel and Corten available
- Proprietary in house fabricated slender profiles
- 1" Simulated Divided Lite option to minimize every sight line
- 1" or 1-1/4" True Divided Lite option for that true steel look and feeling
- Corner Welded Glazing Bead (not just caulked) to avoid leaking in corners
- Five optional glazing bead options
- NFRC Rated to comply with building code
- Dual insulated Cardinal LowE glass with optional Triple Glaze for added insulation
- Factory wet glaze glass system eliminates exterior moisture penetration
- Welded stainless steel hinges with vertical adjustable hinge post
- 4 Different Continuous Solid Steel Welded Nail Flange options for added strength and moisture protection
- Premium Paint Finishes: Six matte and Five Patina
- Exceptional 10-year warranty
- Outstanding service from Concept to Completion

CLASSIC STEEL AVAILABLE IN:

- FIXED WINDOWS
- CURAIN WALL SYSTEMS
- CASEMENT WINDOWS- PUSH OUT AND ROTO CRANK OUT
- AWNING WINDOWS- PUSH OUT AND ROTO CRANK OUT
- GAS SPRING AWNING WINDOWS
- HOPPER WINDOWS
- SLIDING AND MULTI-SLIDE WINDOWS
- LIFT & SLIDE WINDOWS
- TILT & TURN WINDOWS
- HORIZONTAL & VERTICAL CENTER PIVOT WINDOWS
- CIRCLE, OVAL, OCTOGON, RAKE SHAPE WINDOWS
- BUTT GLAZED CORNER WINDOWS
- SWING IN & SWING OUT DOORS
- FIXED AND OPERABLE SIDELITES
- BI-FOLD DOORS
- SLIDING AND MULTI-SLIDE STACKING DOORS
- SLIDING AND MULTI-SLIDE POCKETING DOORS
- LIFT & SLIDE STACKING DOORS
- LIFT & SLIDE POCKETING DOORS
- PIVOT DOORS
- DUTCH DOORS
- TILT-UP DOORS
- HANGER DOORS

CLASSIC SERIES DOOR DETAILS:

Door Opening Configurations

DOOR IN-SWING

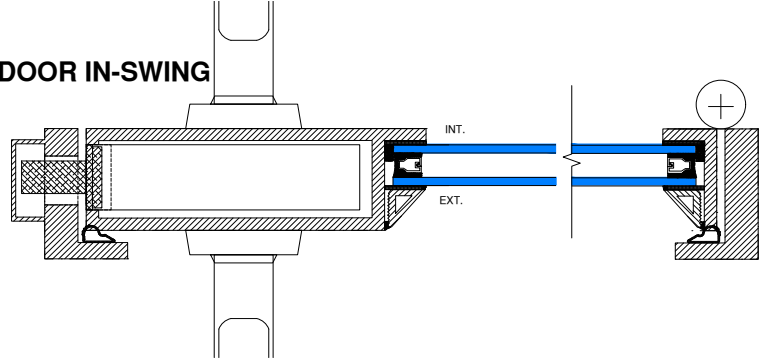

DOUBLE DOOR IN-SWING

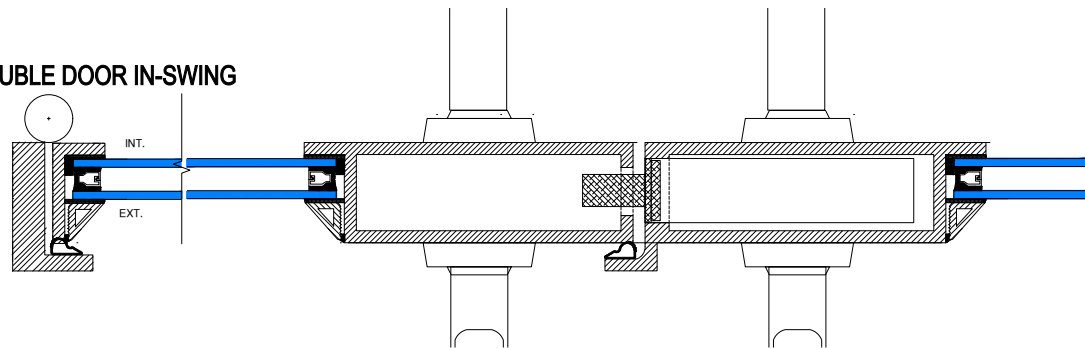

DOOR OUT-SWING

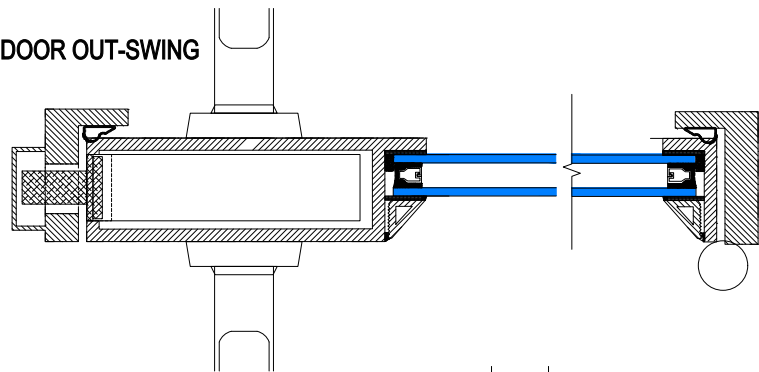

DOUBLE DOOR OUT-SWING

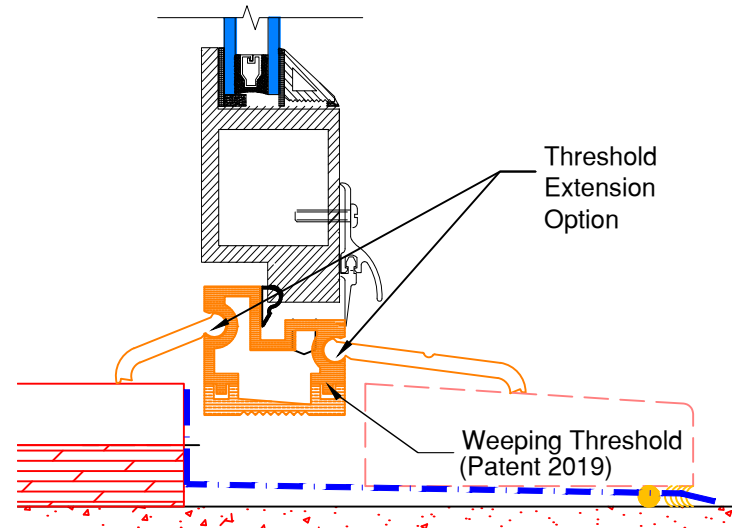
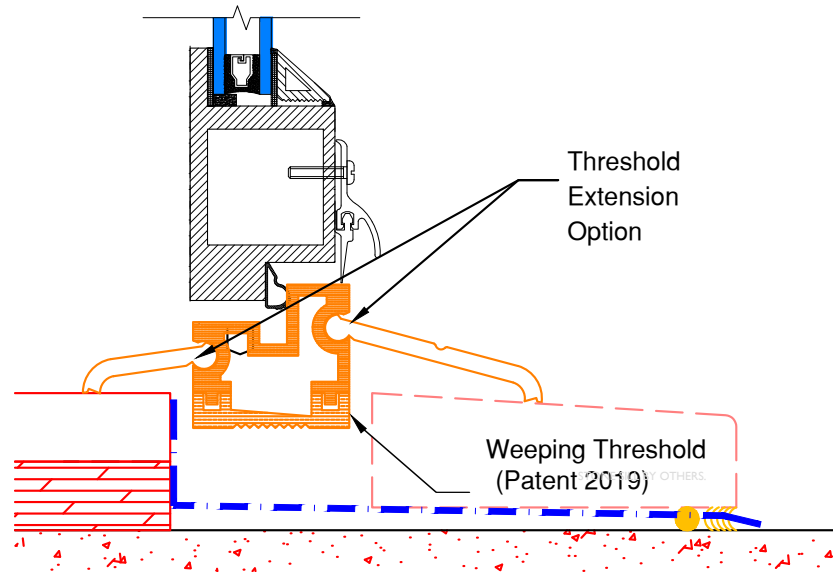
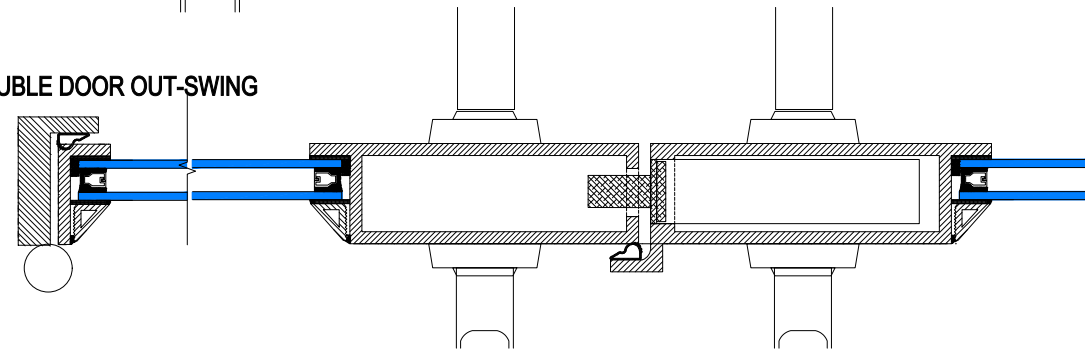

CLASSIC SERIES STEEL WINDOW DETAILS:

Opening Configurations

FIXED

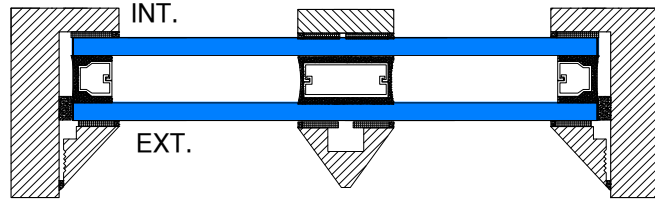

CASEMENT

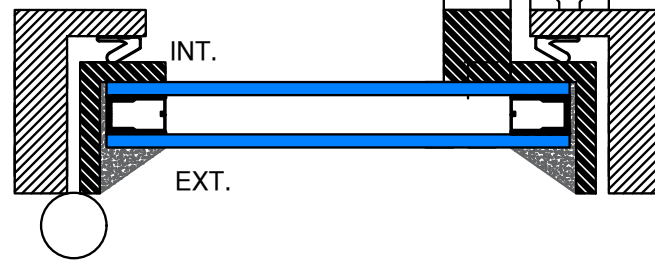

FRENCH CASEMENT

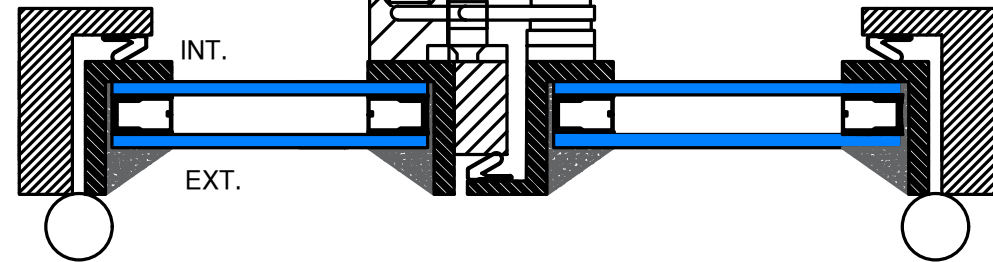

Exterior Detail



Interior Detail



Tight Reveals

Seamless, Beveled
Deep Glazing

Crisp, Clean
Points of Intersection





In order to meet the rising demand of boutique commercial projects requesting steel windows and doors on restricted budgets, Portella has created a STOREFRONT Series for both exterior and interior applications.

- Precision Carbon Steel profiles
- Solid Bronze and Corten available
- Trues thermal broken frame and sash
- Proprietary made in house profiles
- True Divided Lite or Simulated Divided Lite options
- Several glass options including electric privacy glass
- Factory wet glaze glass system eliminates exterior moisture penetration
- Commercial hardware options such as Closers, Panic Devices, Auto Door Bottoms, Electric Latches, Low Profile Sills etc.
- Welded stainless steel hinges with vertical adjustable hinge post
- 4 Different Continuous Solid Steel Welded Nail Flange options for added strength and moisture protection
- Thermally-bonded zinc galvanizing corrosion resistant coating.
- Premium Paint Finishes: Six matte and Five Patina
- Exceptional 10-year warranty
- Outstanding service from Concept to Completion

STOREFRONT STEEL AVAILABLE IN:

- FIXED and CURTAIN WALL SYSTEMS
- CASEMENT and AWNING WINDOWS- PUSH OUT AND ROTO CRANK OUT
- HOPPER WINDOWS
- HORIZONTAL, VERTICAL CENTER PIVOT and TILT & TURN WINDOWS
- CIRCLE, OVOL, OCTOGON, RAKE SHAPE WINDOWS
- BUTT GLAZED CORNER WINDOWS
- SWING IN & SWING OUT DOORS
- SLIDING AND MULTI-SLIDE STACKING & POCKET DOORS
- PIVOT DOORS

STOREFRONT EXTERIOR & INTERIOR DOOR AND WINDOW DETAILS:

Door Opening Configurations

DOOR OUT-SWING

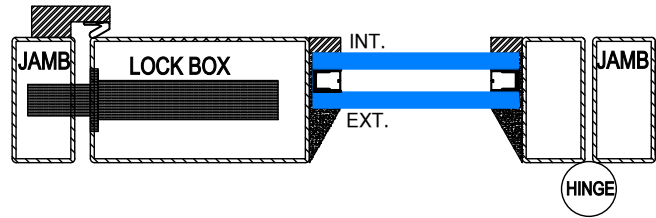

DOUBLE DOOR OUT-SWING

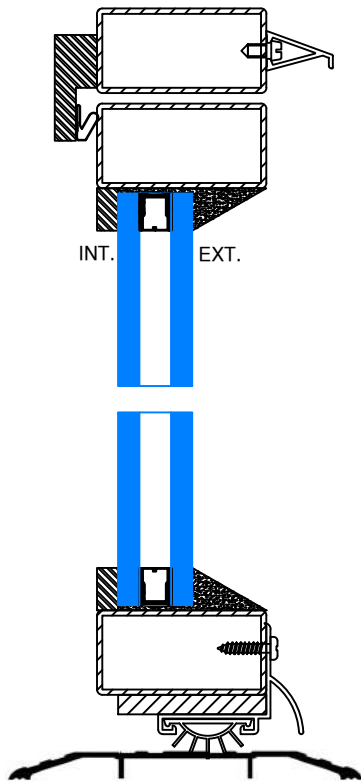
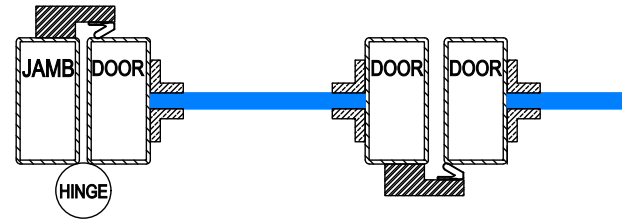

Window Opening Configurations

FIXED

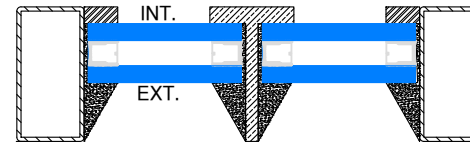

CASEMENT

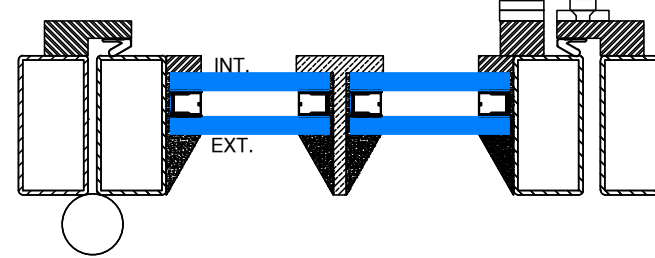

FIXED

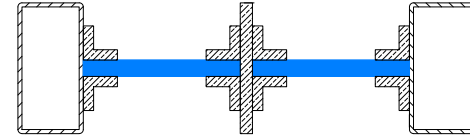

CASEMENT

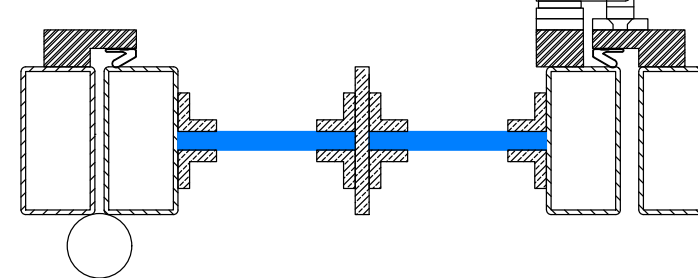



PORTELLA STOREFRONT INTERIOR DOORS CREATE TRANSFORMATIVE INTERIOR OFFICE SPACES.



PORTELLA BIFOLD AND SLIDING DOORS

Dramatically increase your living and entertaining space with a bi-fold or sliding door. Available in Artisan, Classic, and Storefront.



THE PIVOT DOOR

Nothing traditional about this door. Our innovative Pivot Door swings gently on its “invisible” hinge, opening and closing with just a touch. Customize your Pivot design with a unique panel layout and with frosted or clear insulated glass. Available in Artisan Steel and Storefront.

PORTELLA STAINLESS STEEL SHOWER AND SAUNA DOORS ARE AVAILABLE IN BOTH CLASSIC AND THERMAL SERIES.





MODERN DESIGNS

Make a statement with an ultra-contemporary entry. Portella Doors also offers a line of sleek, innovative designs to complement modern home architecture and urban lifestyles.

Standard Specifications

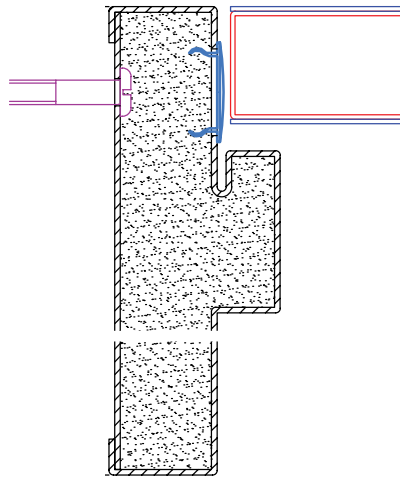

Thermal Steel Specifications

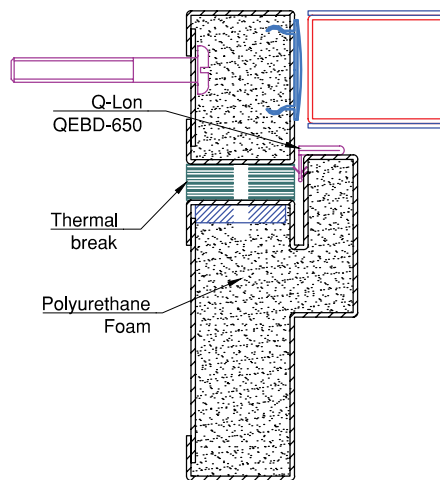



CASEMENT WINDOW HARDWARE



FA 0340 (Standard)



FA 0314



FA 0309

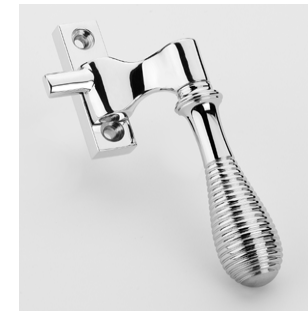

FA 0301



FA 0310



RM LC300



CASEMENT STAY BAR (Standard)



CASEMENT SLIDE STAY



STANDARD HINGE,
STAINLESS
Concealed friction 4 bar
hinge also available.

ROTO CRANK OPTION



CRANK OUT



CASEMENT FASTENER

SWING DOOR/BI-FOLD DOOR HARDWARE

Rocky Mountain Artisan Series Multi Point



Rocky Mountain Artisan & Classic Series Mortise Box



SWING DOOR/BI-FOLD DOOR HARDWARE

Baldwin Artisan Series Multi Point



Lakeshore Trim



Concord Trim



Bismark Trim



Boulder Trim



Richland Trim



Bristol Trim



5162 Tube Flat O

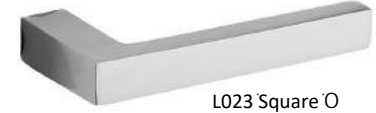

L023 Square O

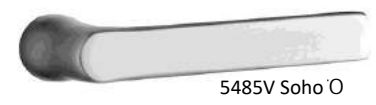

5485V Soho O



5190 Square Taper O



5103 Curl O



L022 Curved O



L020 Flat Thin O



5137 Tube Straight L



5164 Flat Curved L



5452V Bevertail L



5161 Tube Notched L



5173 Tube Mitered O

Baldwin Artisan & Classic Series Mortise Box



Lakeshore Trim



Houston Trim



Bismark Trim



Nashville Trim



Bristol Trim



(003) Lifetime Polished Brass



(033) Vintage Brass



(050) Satin Brass and Black



(055) Polished Nickel



(056) Satin Nickel



(151) Antique Nickel



(260) Polished Chrome



(264) Satin Chrome



(452) Distressed Antique Nickel



(102) Oil Rubbed Bronze



(112) Venetian Bronze



(190) Satin Black



(402) Distressed Oil Rubbed Bronze



(412) Distressed Venetian Bronze

SWING DOOR/BI-FOLD DOOR HARDWARE

Ashley Norton Artisan Series Multi Point



SQUS4 Trim



AGUS4 Trim



SPUS4 Trim



SQUSS5 Trim



450 Apollo O



500 Churchill U O



400 Hampton O



490 Colonial O



360 Fountain O



478 Mason O

Ashley Norton Artisan & Classic Series Mortise Box



MDMOR Trim



SPMOR Trim



AGMOR Trim



CVMOR Trim



WM
White Medium



WL
White Bronze



BZ
Dark Bronze



TC
Matt Black



LT
Light Bronze

SWING DOOR/BI-FOLD DOOR HARDWARE

Hoppe Artisan Series Multi Point

Hoppe Artisan Series Multi Point

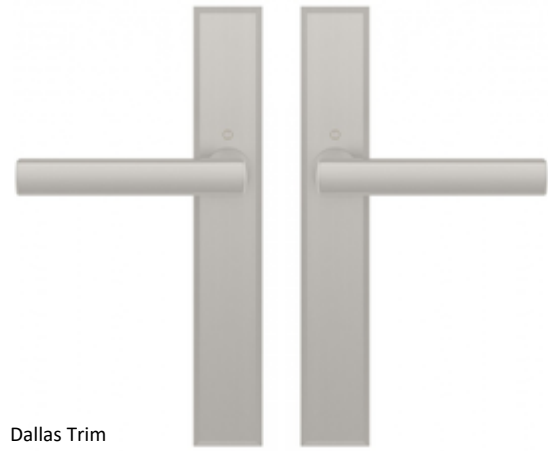

Dallas Trim

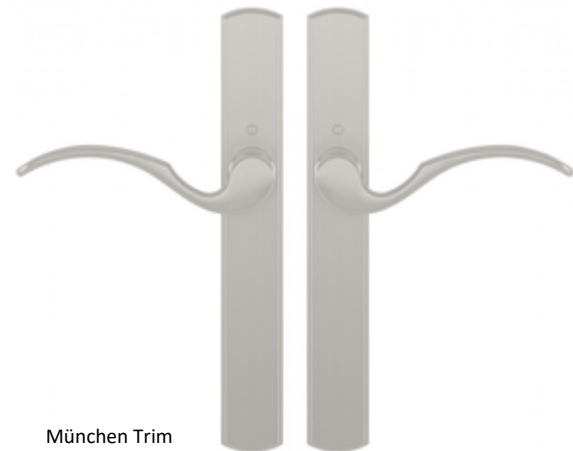

München Trim

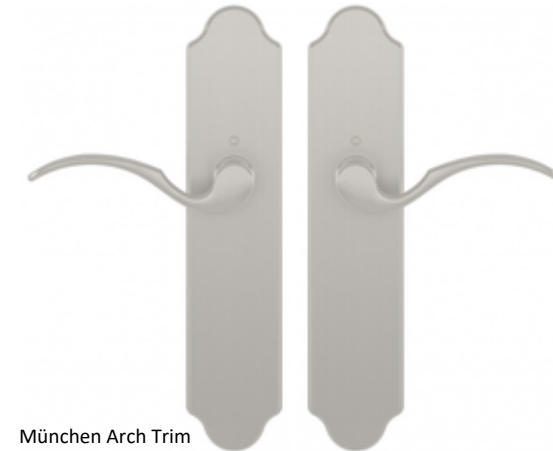

München Arch Trim

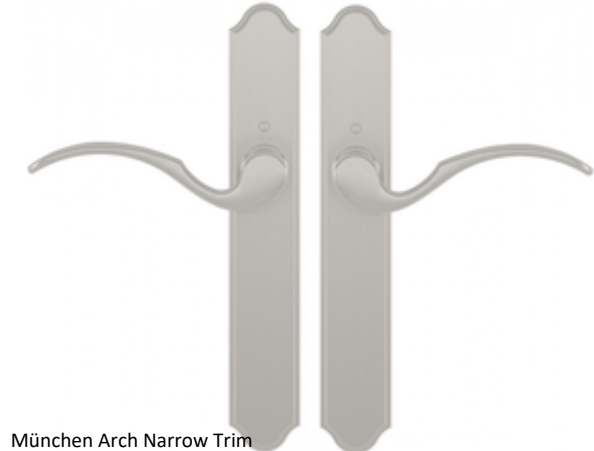

München Arch Narrow Trim



Ródos Trim

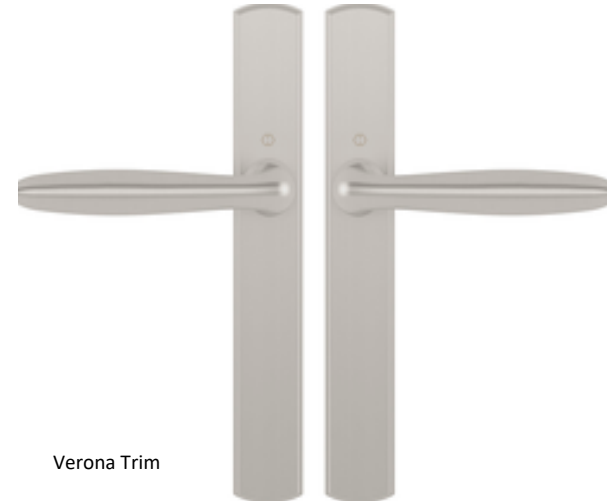

Verona Trim



Toronto Trim

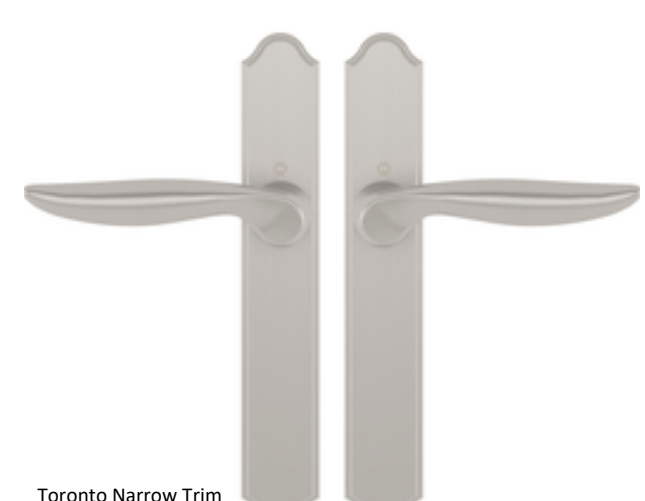

Toronto Narrow Trim

Polished Brass

Antique Brass

Matte Black

Polished Chrome

Brushed Chrome

Satin Nickel

Oil Rubbed Brass

Antique Nickel

Rustic Umber

Bronze Metallic

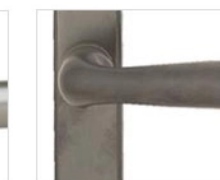
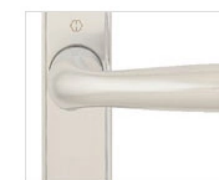
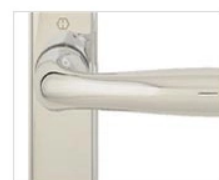

SWING DOOR STANDARD FEATURES

PATENT SOLID BRONZE THRESHOLD
with WEEP SYSTEM



THRESHOLD SHOWN with
OPTIONAL EXTENSION

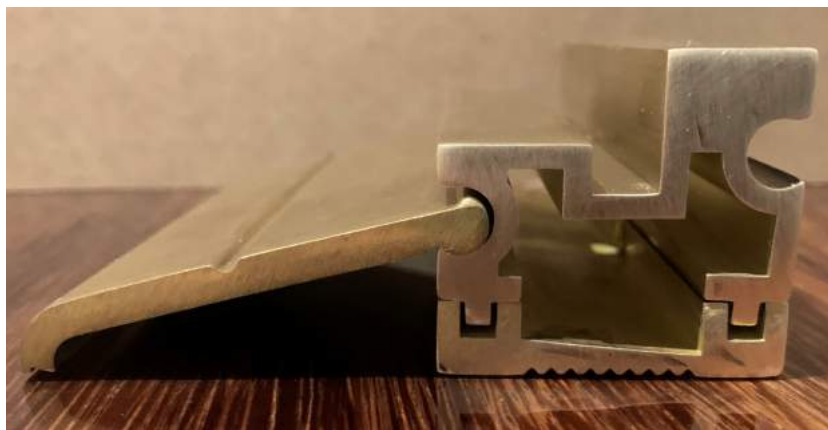

THRESHOLD TOP VIEW
with WEEP SYSTEM



ADJUSTABLE STEEL POST IN
BARREL w /BALL BEARING



5 POINT MULTI-POINT LOCK SYSTEM ON PRIMARY and
SECONDARY ARTISAN DOORS



MORTISE LOCK SYSTEM ON CLASSIC and ARTISAN
DOORS

Classic Series
Flush Bolts
STANDARD

CUSTOMIZE YOUR BEAUTIFUL NEW PORTELLA PRODUCT

Custom Window Hardware



RM WC100



RM WC160



RM Custom

Custom Lift & Slide Door Hardware



RM Corbel Arched



RM Convex



RM Folding



RM Hammered



Custom Top Hung Barn Door Track



RM BDH

Cromone Bolts for Casements & Swing Doors

NOT AVAILABLE ON ALL HEIGHTS



SVB CS-CB409



SVB CB L-105



FA 085 I

COLOR AND FINISH OPTIONS

Our products are available in standard paint finishes.
Custom paint colors and finishing are also available.



GUNMETAL



DARK BRONZE

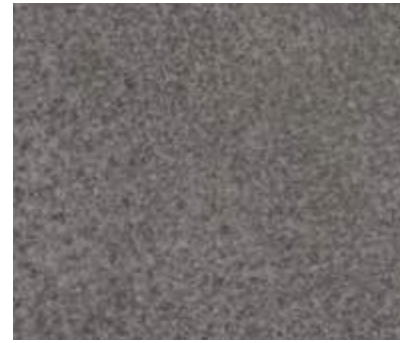

PEWTER



ANTIQUÉ BRONZE



GRAY



CHESTNUT BROWN



RUSTIC COPPER



YOUR CUSTOM COLOR HERE

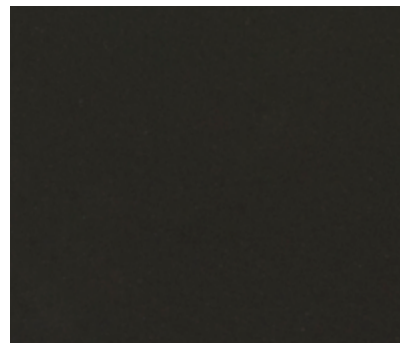

BLACK

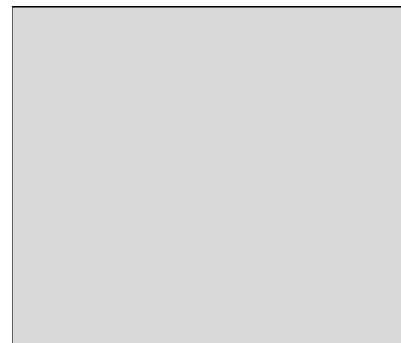

DOVE GRAY

Portella takes pride in giving one of the industries most durable, long lasting finishes.

Portella controls our paint finish by applying every layer onto the raw steel ourselves. We do not use third party to apply our Zinc Galvanize or paint coats.

Every items starts with:

- Thermal Bonded Galvanization to protect the steel from rust.
- First coat of Epoxy Base Primer
- Second coat of Epoxy Base Primer
- First coat of Acrylic Lacquer Paint
- Second coat of Acrylic Lacquer Paint
- Top coat of 2k Clear Urethane for added strength against the elements





4111 TODD LANE SUITE G,
AUSTIN, TEXAS 78704 5

TOLL FREE: 877.263.8851

PORTELLA.COM